

MindLAMP App Instructions

For Participants

Download

- Download mindLAMP 2 app on the app store
- Then click on the sign-in link from the email
 - Or go to next slide to see sign-in instructions

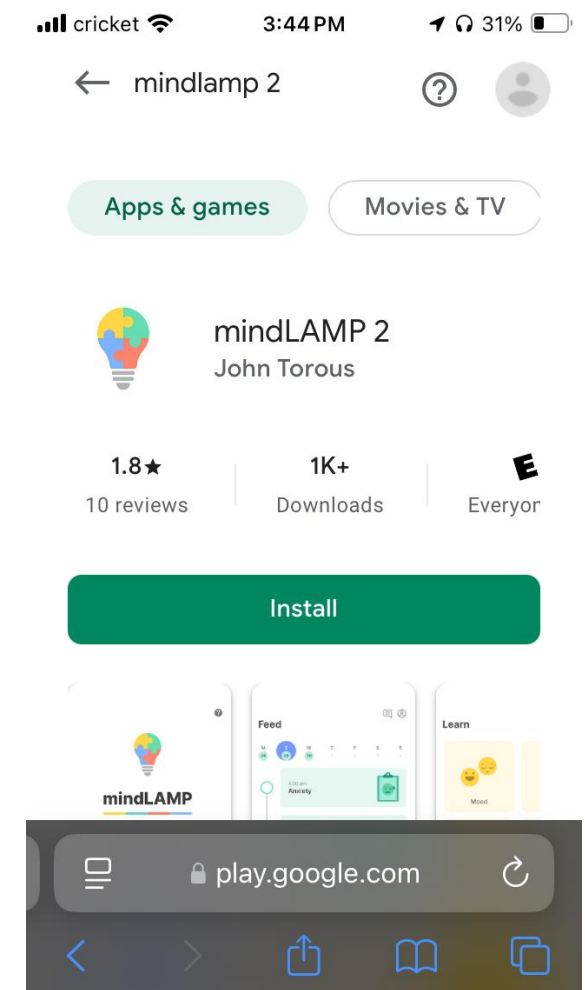
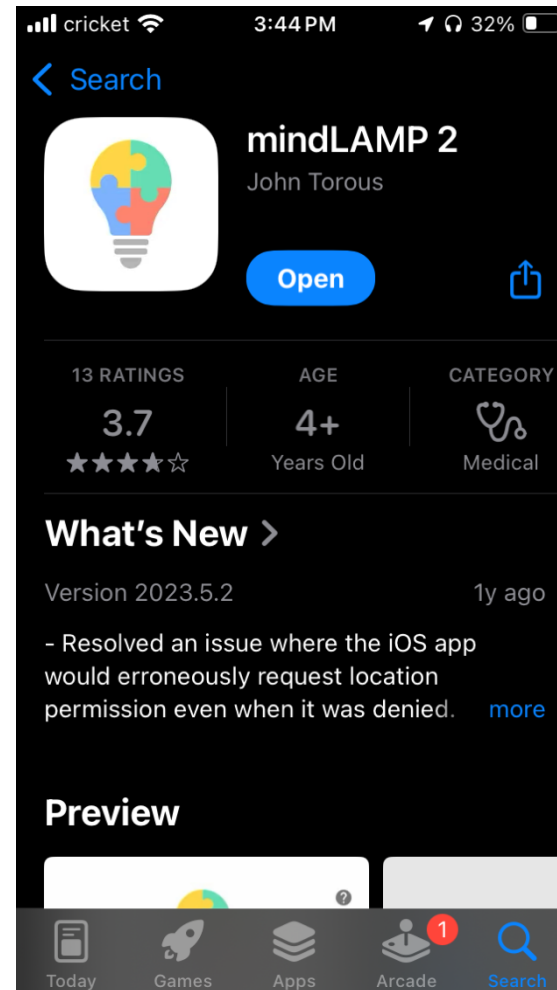

Step 1

- Open app
 - Enter in server address*
api.mindlamp.itpmclean.org
- *This is NOT one of the dropdown options, you must type it in
- Enter in username and password, given to you by the study staff.
Something like:

- [Username: qualr200@lamp.com](mailto:qualr200@lamp.com)
- Password: Xt30fw

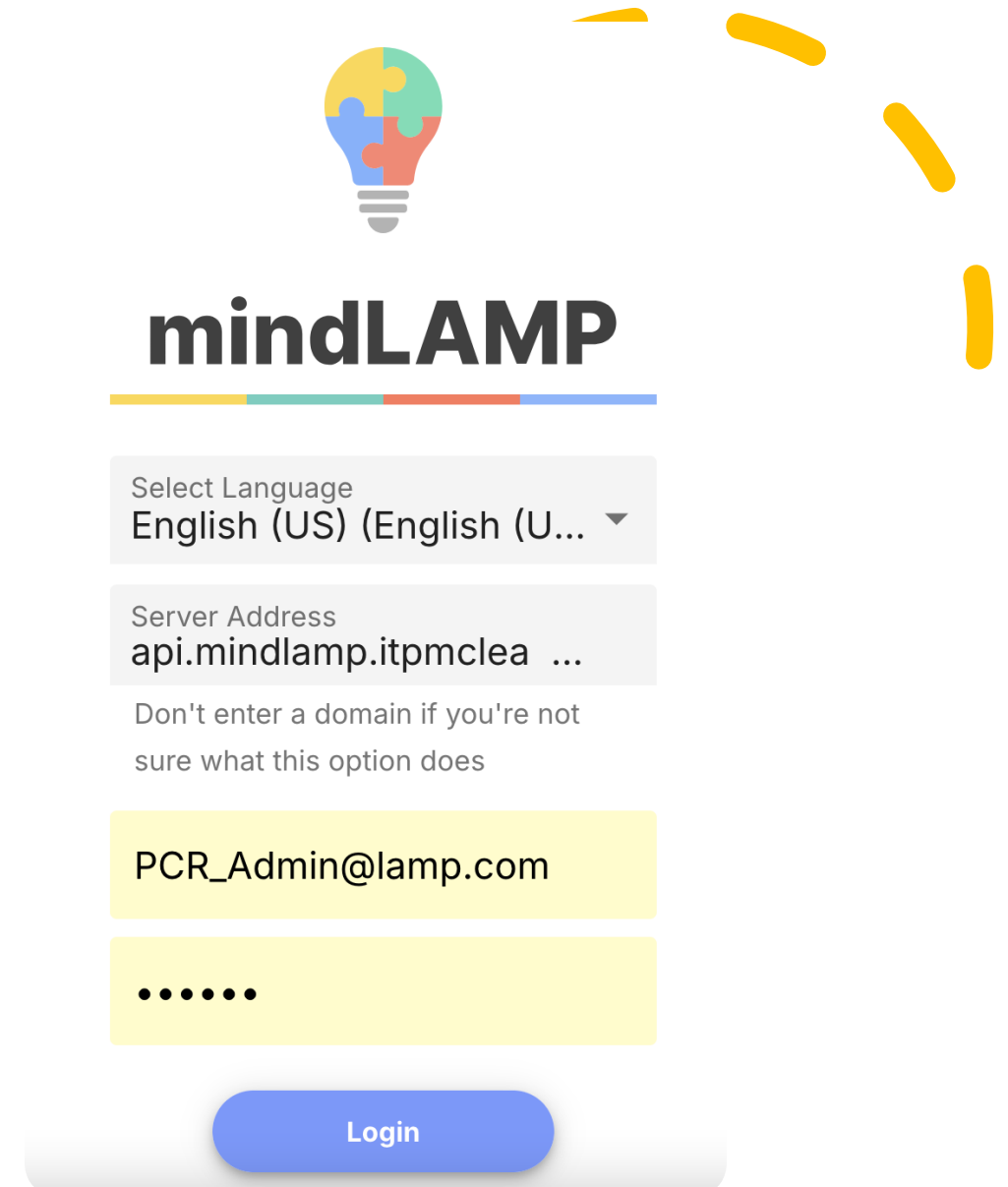

The image shows the mindLAMP app interface. At the top is a logo of a lightbulb made of colorful puzzle pieces. Below the logo is the text "mindLAMP" in a bold, black font. Underneath is a horizontal bar with four colored segments: yellow, teal, orange, and blue. The interface has two main input sections. The first section is titled "Select Language" and shows "English (US) (English (U...)" with a dropdown arrow. The second section is titled "Server Address" and shows "api.mindlamp.itpmclea ..." with a dropdown arrow. Below these is a note: "Don't enter a domain if you're not sure what this option does". There are two yellow input fields. The first contains the email "PCR_Admin@lamp.com". The second contains five dots, representing a password. At the bottom is a blue "Login" button.

mindLAMP

Select Language
English (US) (English (U... ▼

Server Address
api.mindlamp.itpmclea ...

Don't enter a domain if you're not sure what this option does

PCR_Admin@lamp.com

.....

Login

Update Settings: iOS

- Set Location Services to “Always” on their phone settings
- Ensure that notifications and GPS location tracking are enabled.

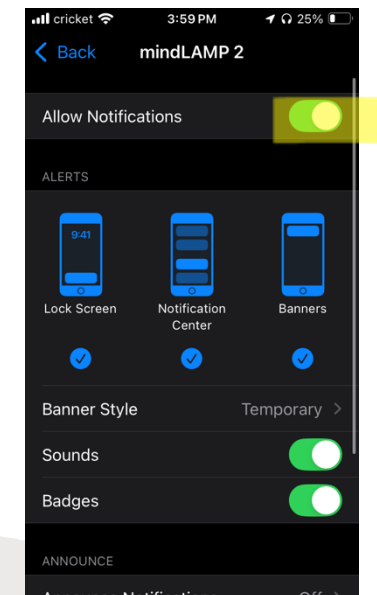
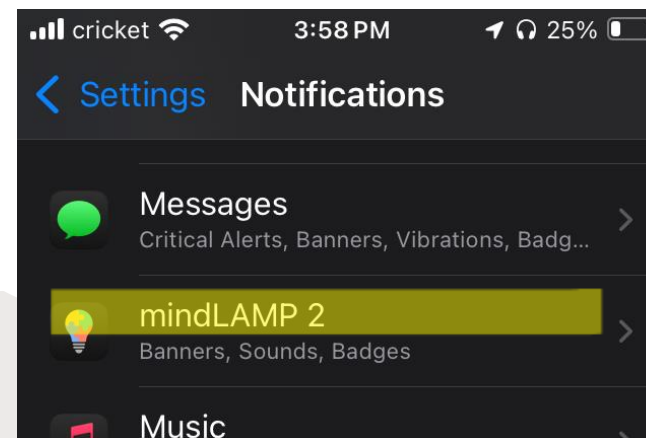
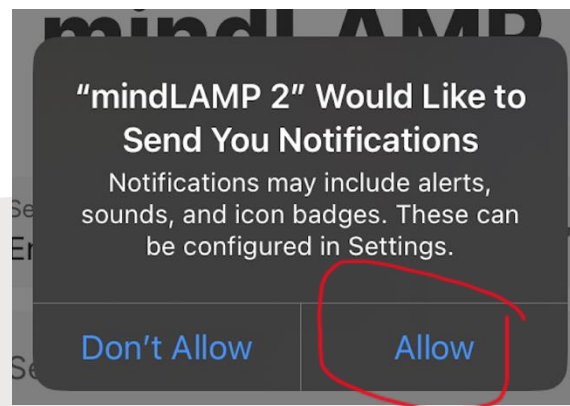
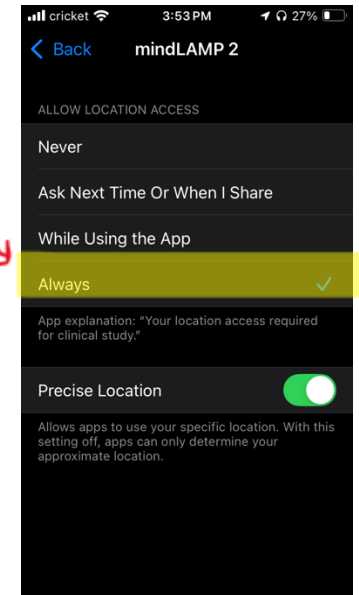
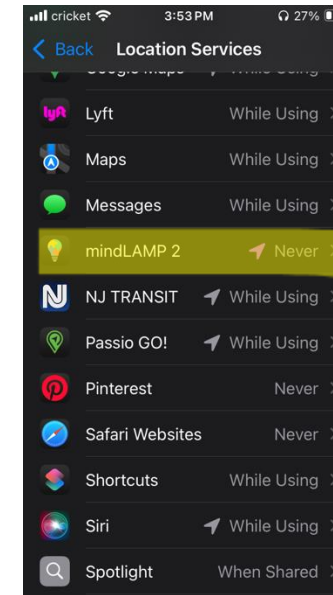
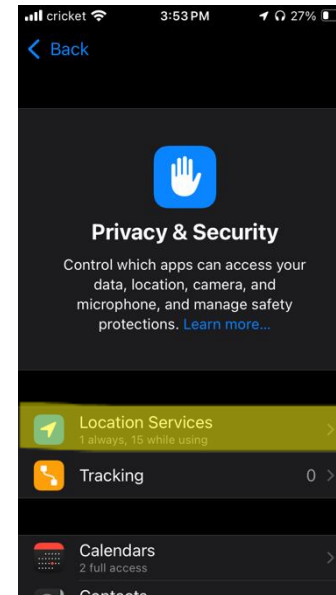
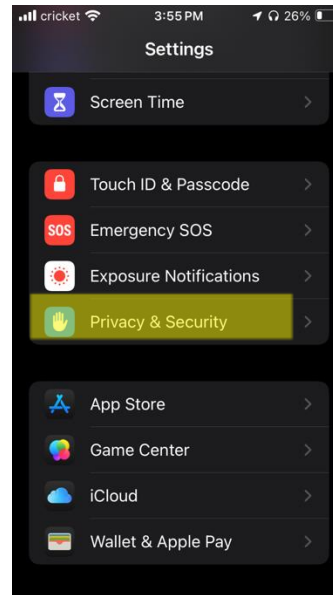

Update Settings: Android

- Set Location Services to “Always” on their phone settings
- Ensure that notifications and GPS location tracking are enabled.

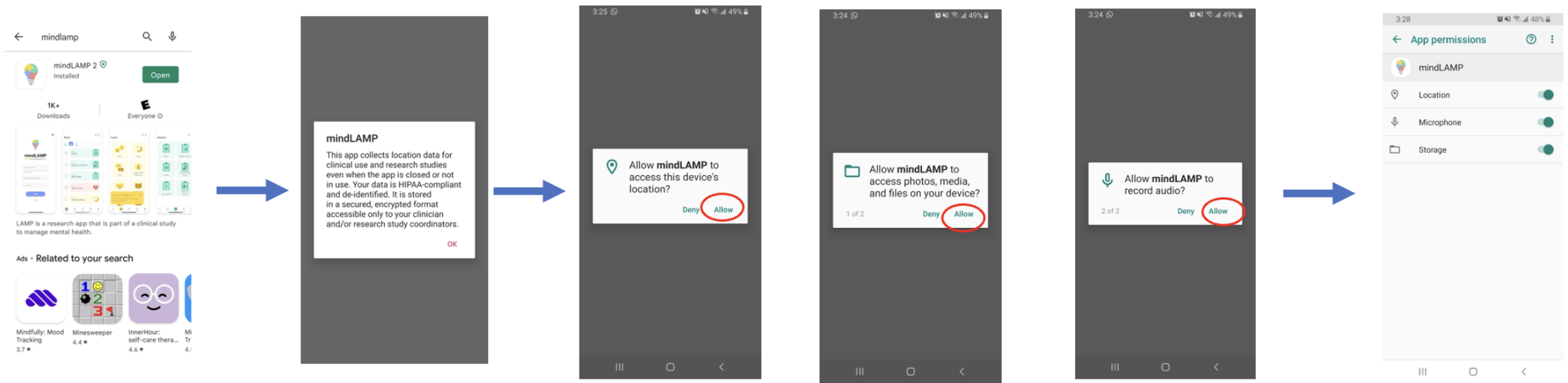

App Instructions

Daily Survey

MindLAMP App Flow

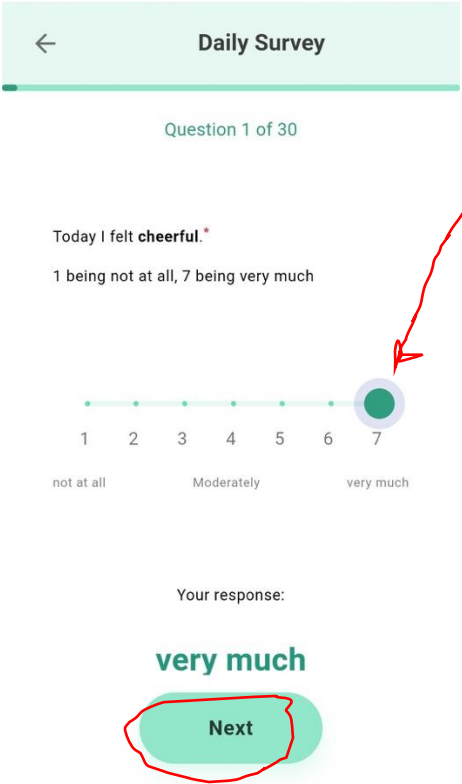
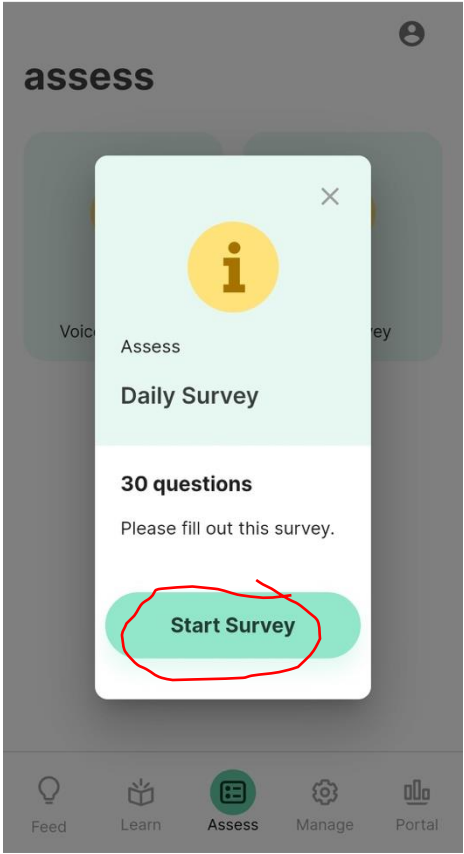

v1871 (2022.2.22)

Then select
"Next"

Use slider
to indicate
your
answer to
the
question

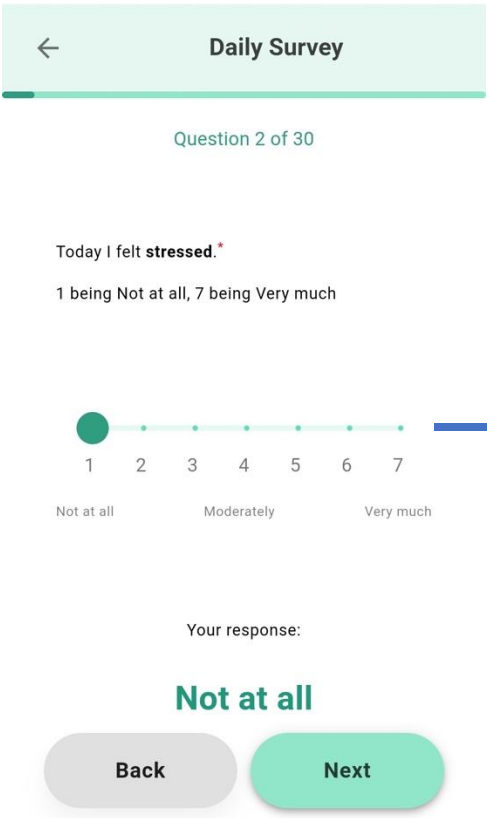

v1871 (2022.2.22)

